



DEPARTMENT OF
ECOLOGY
State of Washington

Proposed Rulemaking for Chapter 173-50 WAC Accreditation of Environmental Laboratories

Laboratory Accreditation Unit, 11/30/2022

Zoom Navigation and Accessibility

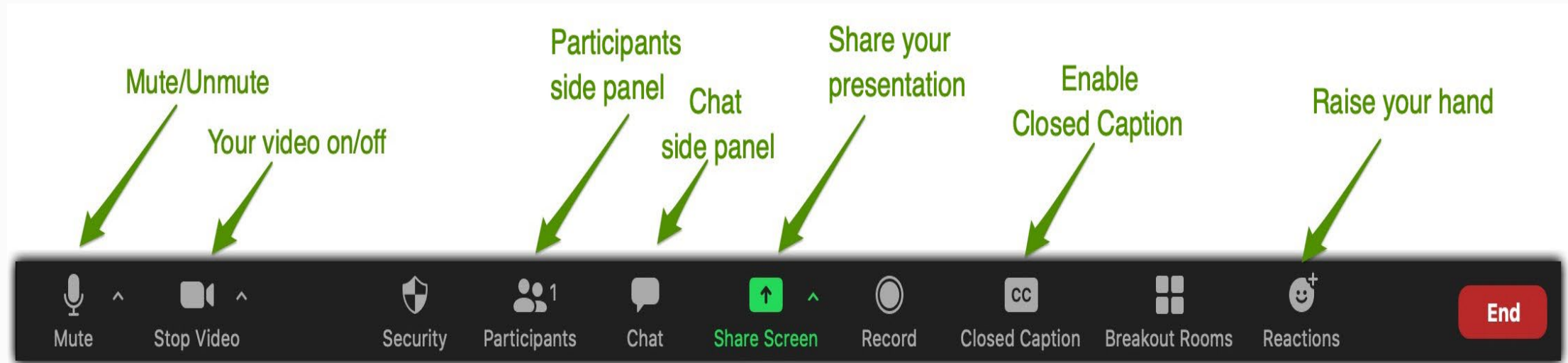

Calling by phone?

***6 - Mute/unmute**

***9 - Raise/lower hand**

Need help? Chat with us!

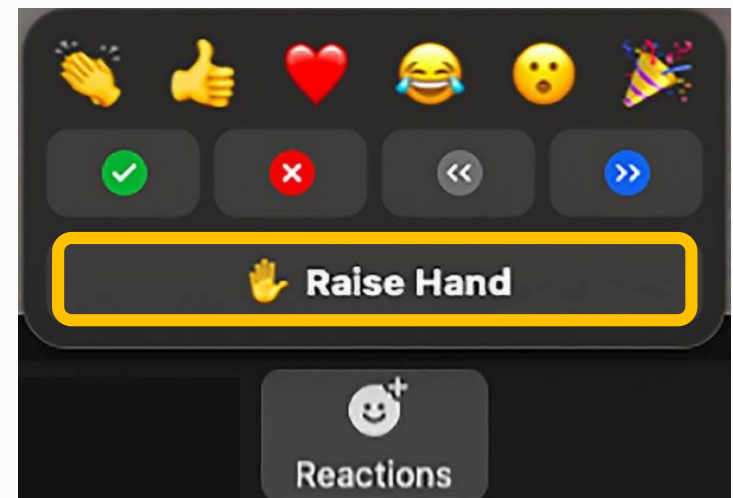

Navigating Zoom features

- Chat
- Raise hand & Reactions
- CC Live Transcript

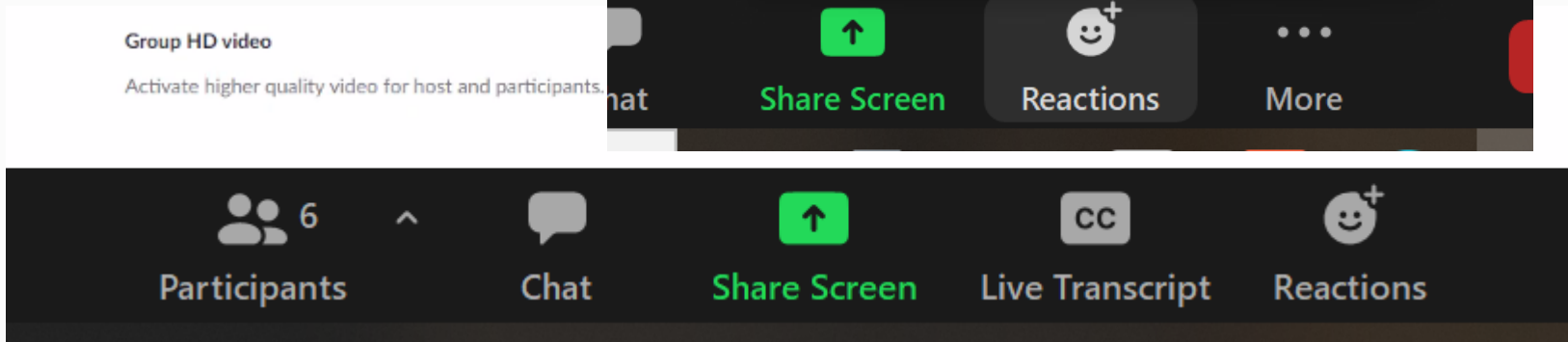
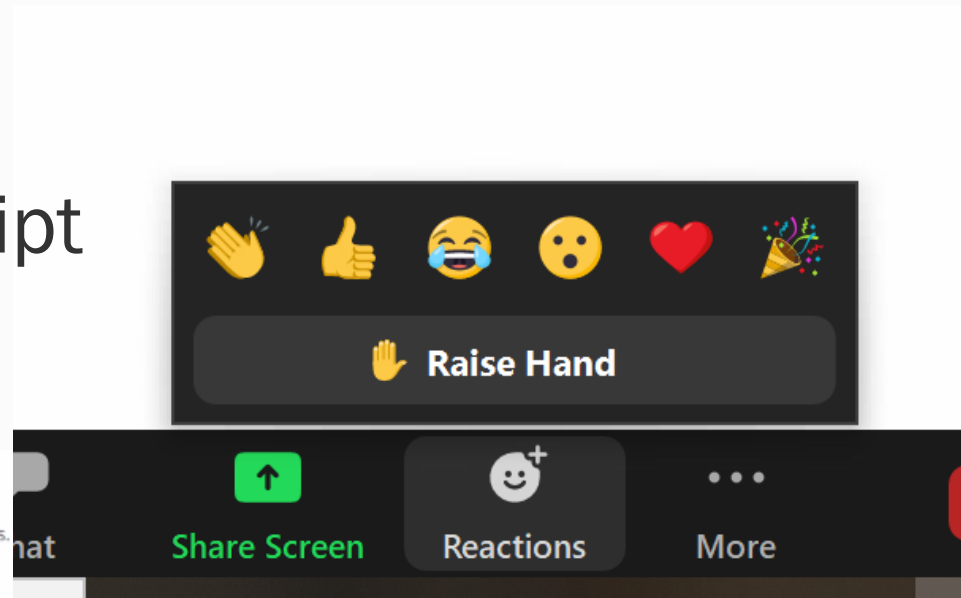



Rulemaking

What is the Process?



Rulemaking Process

- 3 Phases
 - Approval/Announcement
 - Proposal
 - Adoption
- Process-driven

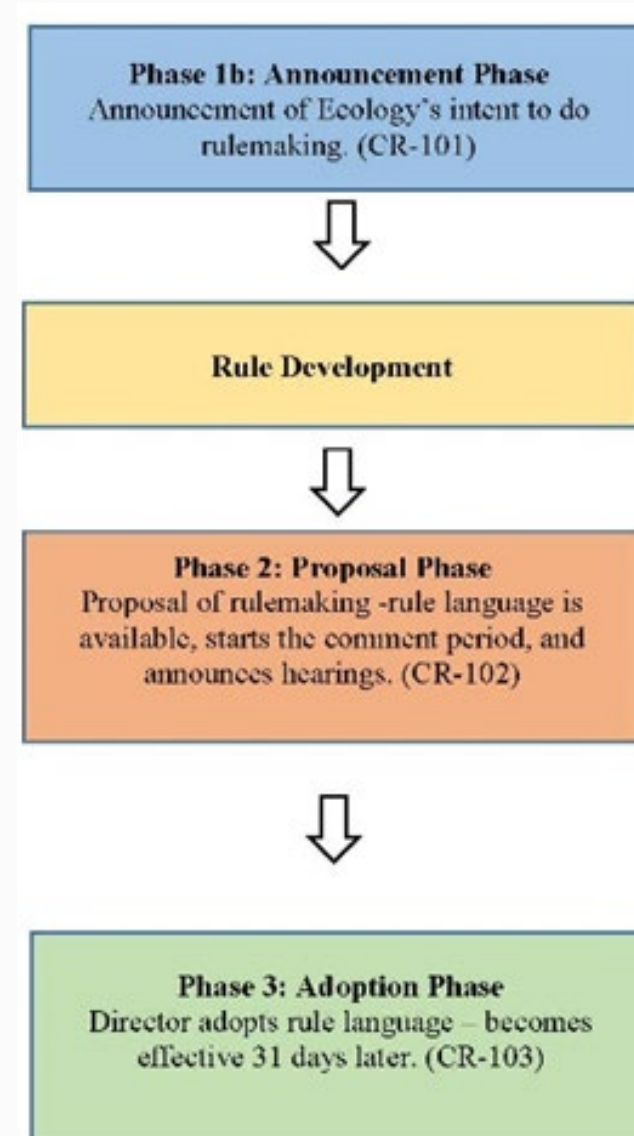

Timeline

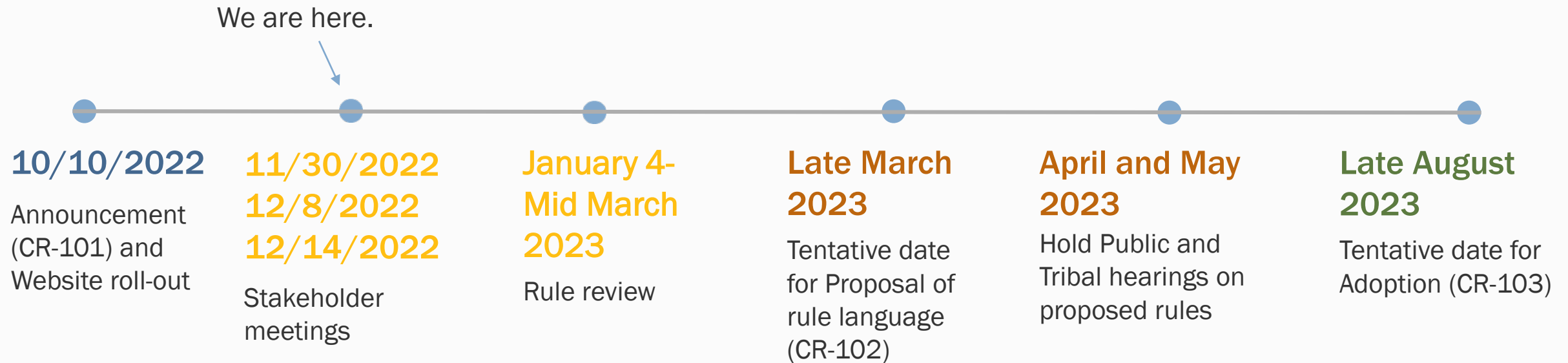



Goals

What are we
aiming to achieve?



Changes since previous rulemaking

- Outdated fee structure
 - Last updated in 2010
- Added complexity
- Novel compounds

Customer service improvements

- Improved turn-around times
- Improved capacity for technical assistance
- Increased audit capacity
 - Both virtual and on-site

WAC language improvements

- Accommodate Mobile laboratories
- Use of more modern technologies
- Protect data integrity and traceability



Strategies

How do we intend to meet our goals?



Rule language adjustments

- Addition of new sections such as
 - data traceability
 - quality control practices
- Add clarity to existing sections
 - PTs
 - Onsite audits
 - Definitions

Fee structure

- Aiming for cost neutrality
- Address gaps
- Initial fee timing

Current Fee Schedule (2010)

WAC 173-50-190

Effective 9/9/2010

CATEGORY	FEE PER PARAMETER	FEE PER METHOD	MAX FEE PER CATEGORY
General Chemistry	80	—	1,600
Trace Metals	—	400	—
Organics I	—	200	—
Organics II	—	500	—
Microbiology	200	—	—
Radiochemistry	250	—	—
Bioassay	300	—	3,000
Immunoassay	80	—	—
Physical	80	—	—

Fee structure cont.

- Cost neutral LAU staff of 14
- Customer service improvements
 - Improved on-time delivery for accreditation actions
 - Return ALL labs to a triennial audit schedule and follow-ups
 - Greater availability for informal technical assistance

Category	Fee per parameter	Per parameter add fee to existing method	Fee per method
General Chemistry	245		
Trace Metals		60	1,230
Organics I		35	615
Organics II		70	1,540
Microbiology	615		
Radiochemistry	770		
Bioassay	925		
Immunoassay	245		
Physical	245		



Thank you

Feedback, Suggestions,
Questions?