

WELCOME

LID Briefing for NPDES Permittees (Cities & Counties) Eastern Washington



Introduction

AWC LID briefing — Eastern WA

— AHBL

- Wayne Carlson
- Len Zickler
- Holly Williams

— HDR

- Robin Kirschbaum

Introduction

PRESENTATION OVERVIEW

- I. Introduction
- II. Why we are here
- III. What is LID?
- IV. What does the permit mean to me & my community?
- V. Questions & Evaluation

Introduction

PRESENTATION OVERVIEW

- Beginning of a 4-5 year training process
 - Permittees
 - Landscapers
 - Composters
 - Engineers
 - Realtors
- Dept. of Ecology is prepared to help
- Feedback for what you need to move forward

Why are we here?

Why are we here?

- Leading cause of water quality impairment is stormwater runoff
- Clean Water Act
 - Framework for stormwater management
- Manage stormwater for two primary purposes:
 1. Flow Control
 2. Water Quality

Why are we here?

Clean Water Act

- Permits are reissued every five years to comply with the Act's MEP standard
- Technology advances change what is deemed “practicable”
 - LID is example of an evolving science and is now required to be allowed

Why are we here?

NPDES Phase II permit

- Ecology reissued the Eastern Washington NPDES Phase II Municipal Stormwater Permit on August 1, 2012 (becomes effective August 2014)
- The new permit will change the focus from “should encourage” to “shall allow”

Why are we here?

LID differs from traditional stormwater management practices in the following ways :

— Traditional practices

- Centralized
- Constructed to collect & remove runoff quickly
- Traditionally to clear & grade the site

— LID practices

- Smaller
- Decentralized
- Integrated within the landscape

What is LID?

What is LID?

- Stakeholders participated in a 2-year process to define LID:

“Low-impact development (LID) is a stormwater and land use management strategy that strives to mimic pre-disturbance hydrologic processes of infiltration, filtration, storage, evaporation, and transpiration by emphasizing conservation, use of on-site natural features, site planning, and distributed stormwater management practices that are integrated into a project design.”

*Source: Department of Ecology's
Phase II Municipal Stormwater Permit*

What is LID?

LID has an important water quality role in jurisdictions even for jurisdictions where infiltration to groundwater is infeasible due to poorly draining soils, shallow depth to bedrock, etc.

What is LID?

Challenges with conventional stormwater facilities

- Large facilities that take up a lot of room
- Aging infrastructure
- Increase runoff volumes
- Increase pollutant discharges
- Create “flashy” storm events
- Reduce groundwater recharge & results in lower stream flows in critical late summer months

What is LID?

Conventional stormwater facilities



What is LID?

LID stormwater facilities

- Reduces volume thereby minimizing high flows
- Removes pollutants from stormwater
- Replenishes streams and wetlands
- Reduces size of conventional stormwater facilities
- Increases open space
- Visually attractive
- Can result in construction and maintenance cost savings
- Can increase densities
- Can increase public safety

What is LID?

LID stormwater facilities

Multiple functions



What is LID?

LID stormwater facilities

Aesthetically pleasing



What is LID?

LID stormwater facilities

Size



What is LID?

LID stormwater facilities

Options for a variety of design challenges

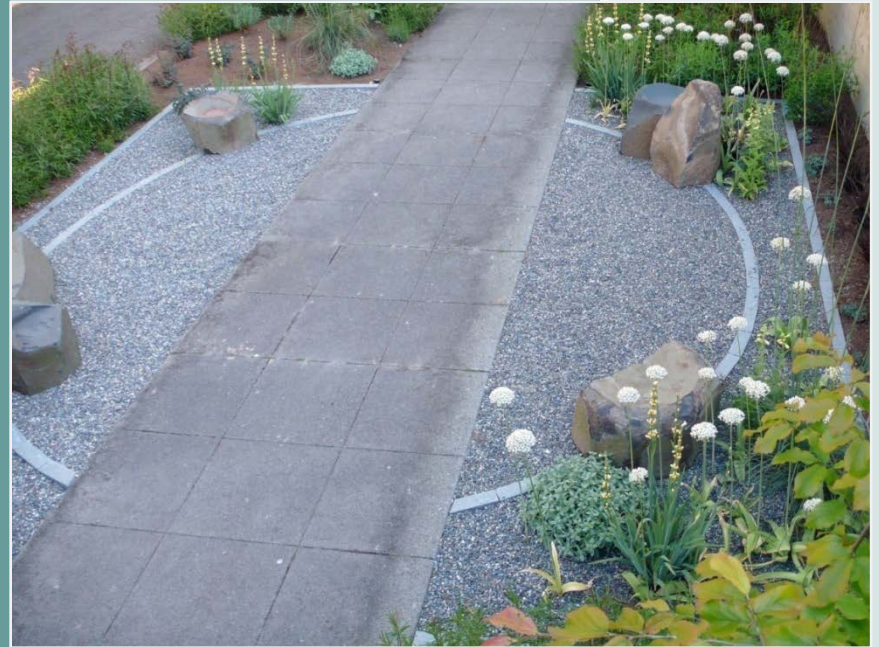

What is LID?

LID stormwater facilities

Maintenance

- LID practices require maintenance
- May be less costly than conventional facilities

What is LID?

LID stormwater facilities

Maintenance



Conventional



LID

What does the new permit mean to me
& my community?

What does the new permit mean to me & my community?

Eastern WA Phase II NPDES permit overview

- Permit becomes effective August 2014
- Permittees must allow the use of LID practices
- This may involve revising and amending local codes and standards to remove barriers to the use of LID

What does the new permit mean to me & my community?

Bioretention

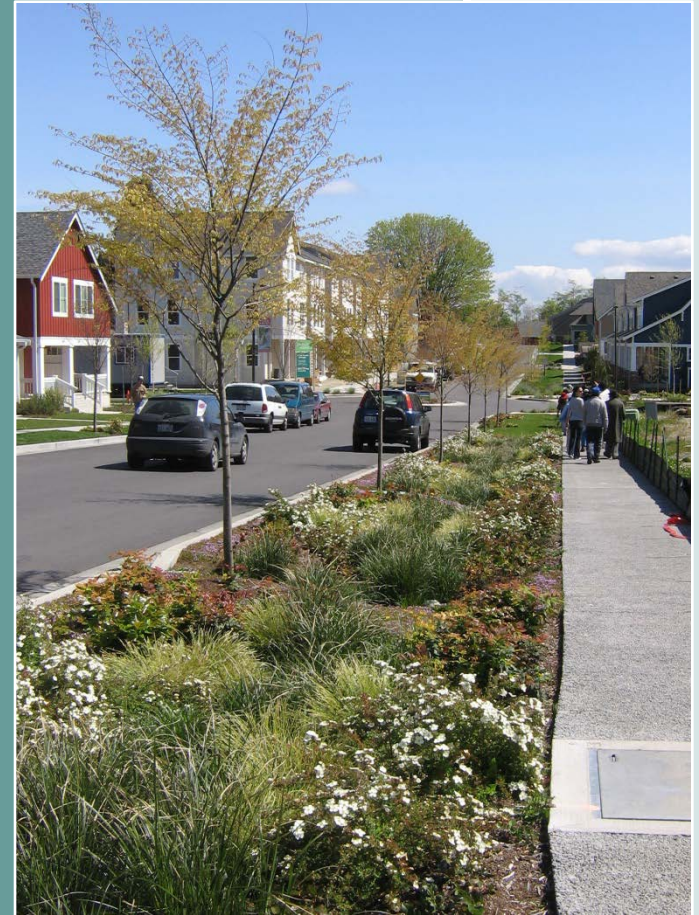

What does the new permit mean to me & my community?

Permeable Pavement



What does the new permit mean to me & my community?

Rain Gardens (small projects only)



What does the new permit mean to me & my community?

Dispersion



What does the new permit mean to me & my community?

Downspout Dispersion



What does the new permit mean to me & my community?

Sheet Flow



What does the new permit mean to me & my community?

Perforated stub-out connections

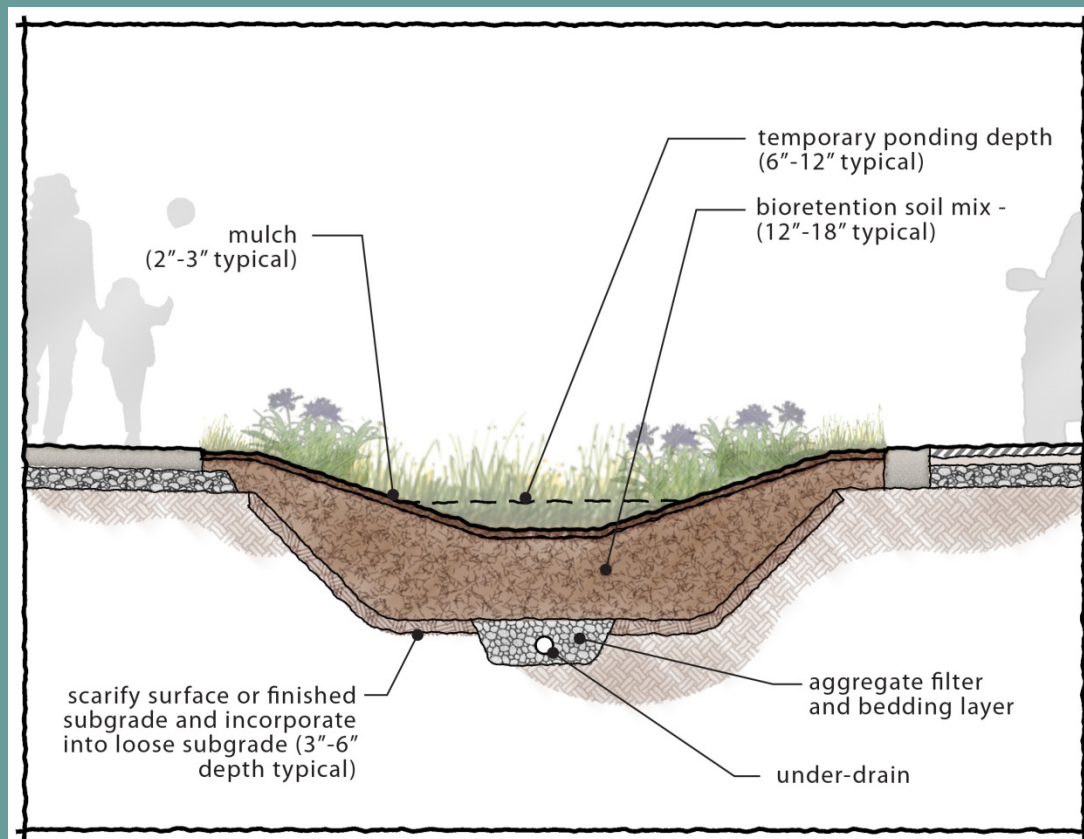

What does the new permit mean to me & my community?

Vegetated roofs



What does the new permit mean to me & my community?

Rainwater Harvesting



What does the new permit mean to me & my community?

Minimal Excavation Foundations



What does the new permit mean to me & my community?

Development Code Review & Amendment Goals

- Reduce impervious surface
- Protect native vegetation
- Reduce stormwater runoff

What does the new permit mean to me & my community?

LID Key Principles

- Allowing LID is more than the structural BMPs. Non-structural practices should also be allowed.
- Non-structural LID principles include:
 - Conserve Vegetation
 - Reduce & Disconnect Impervious Surfaces
 - Distribute small-scale techniques
 - Infiltrate on site

What does the new permit mean to me & my community?

Potential code amendments for implementing LID principles

- Reduced road width
- Changes in road layout and orientation
- Clustering
- Higher building & smaller footprints
- Parking regulations
- Landscaping using bioretention

What does the new permit mean to me & my community?

Site Analysis Code Language

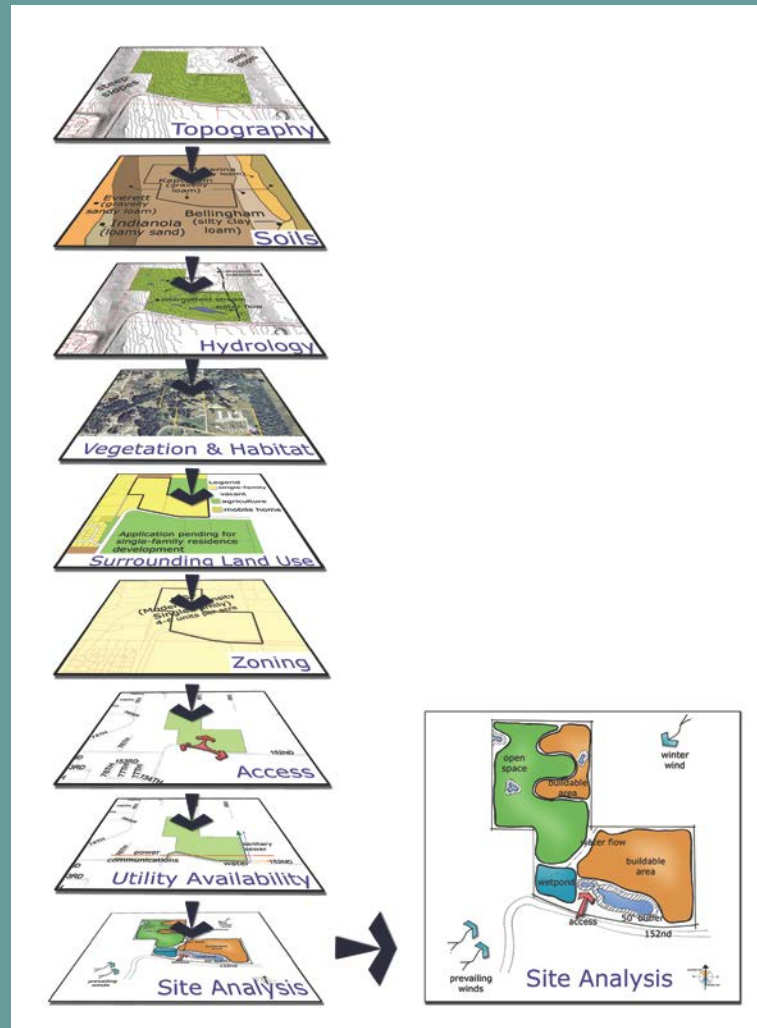

What does the new permit mean to me & my community?

Narrow Road Standards



What does the new permit mean to me & my community?

Road Layout & Orientation Standards

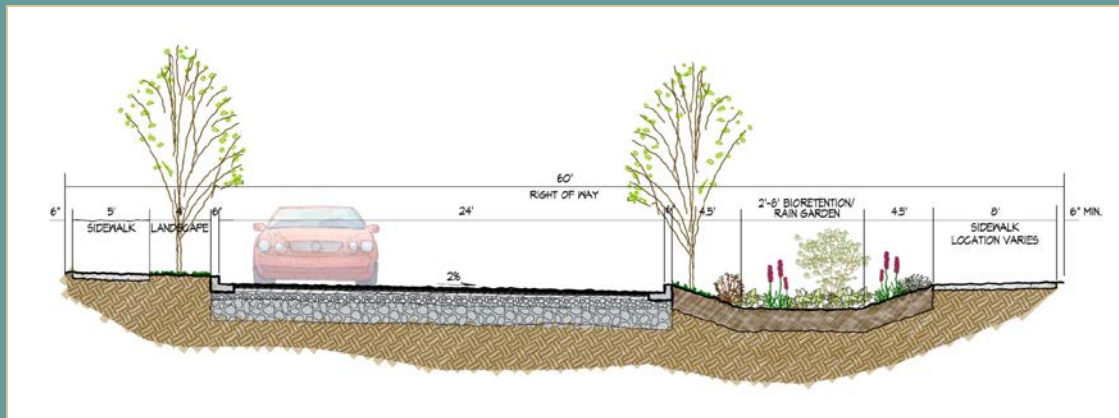

What does the new permit mean to me & my community?

Clustering/PUD Code Provisions

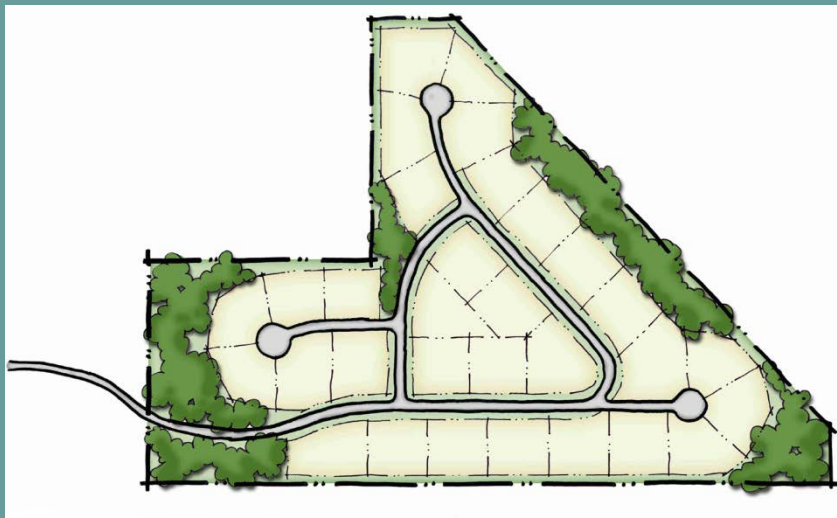

Conventional Design

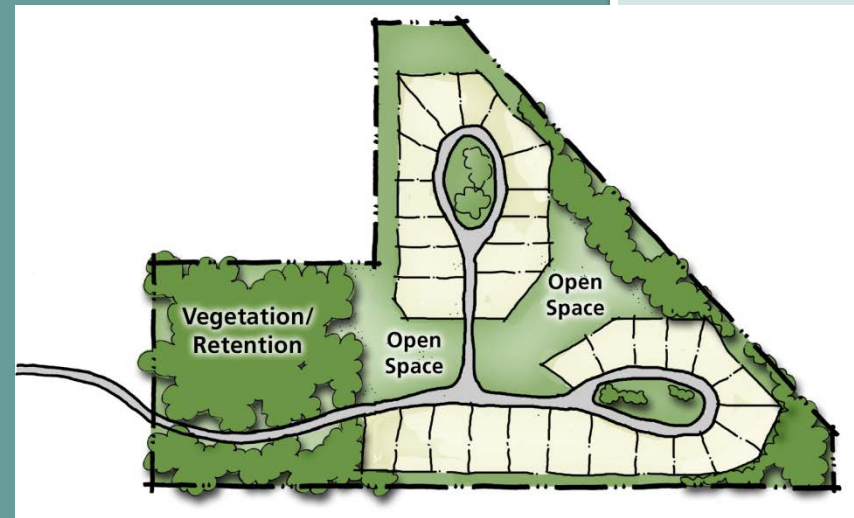

Low Impact Development

What does the new permit mean to me & my community?

Minimizing Impervious Surfaces Through Taller Structures

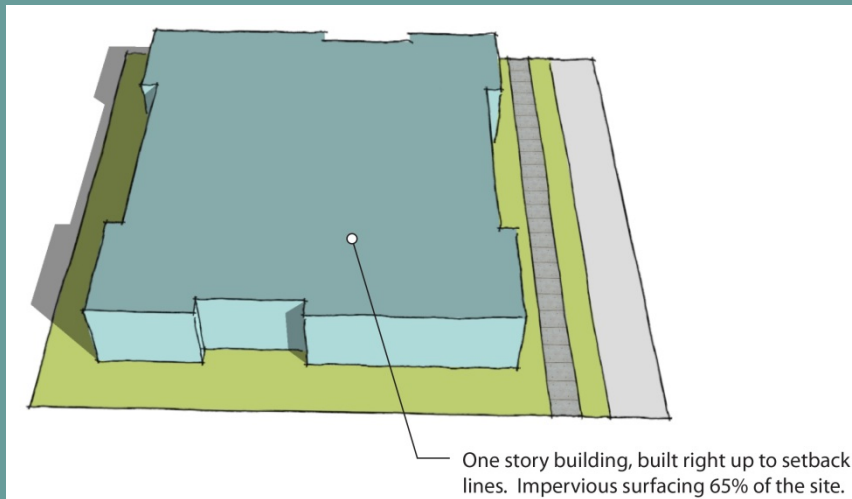

What does the new permit mean to me & my community?

Examining Existing Parking Regulations



What does the new permit mean to me & my community?

Integrating Bioretention Into Required Parking Lot Landscaping



What does the new permit mean to me & my community?

Development Code Review & Amendment

What does the new permit mean to me & my community?

DEADLINES:

December 31, 2017

To remove barriers to the use of LID practices from codes and standards

- Timing was designed to be coordinated with major 10 year GMA updates although not all permittees are required to plan under GMA

What does the new permit mean to me & my community?

STEPS:

1. Assemble Team
2. Understand LID topics to Address
3. Review Existing Codes & Standards for Barriers
4. Remove Barriers
5. Review & Adopt
6. Implementation

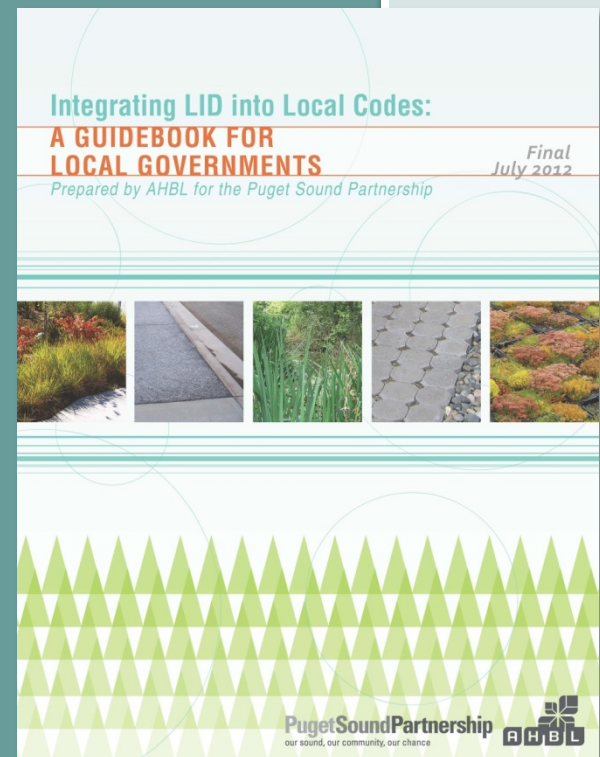

What does the new permit mean to me & my community?

1. Assemble Team

- Large undertaking that will require you to assemble a team of various departments to work together
 - public works, planning, fire marshal, building, maintenance/inspections, etc.



What does the new permit mean to me & my community?

2. Understand LID topics to Address

- Site planning
- Healthy soils
- Landscaping, native vegetation & street landscaping
- Hard & impervious surfaces
- Bulk & dimensional standards
- Clearing & grading
- Streets & roads
- Parking
- Design Guidelines & Standards
- Stormwater & maintenance management
- Subdivision & planned use development
- Critical areas & shoreline management

What does the new permit mean to me & my community?

3. Review Existing Codes & Standards (Barriers Analysis)

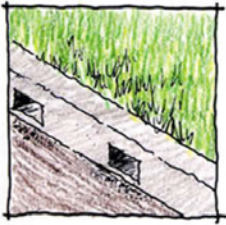
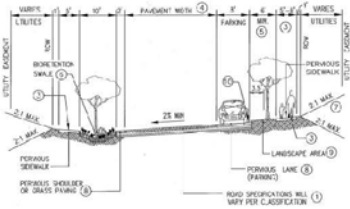
BENCHMARK/OBJECTIVE	CODE REFERENCE AND SUMMARY OF EXISTING STANDARD	GAP BETWEEN EXISTING STANDARD AND BENCHMARK (OPPORTUNITY TO IMPROVE)
<p>Are curb and gutters required for most residential street sections?</p> 	<p>§ 9-4.159 – Curbs, Gutters and Sidewalks</p> <p>Standard Drawing Nos. 401, 402, 405</p>	<p>Yes. Within the urban services line, residential street sections (local) are required to have curb and gutter. Outside the urban services line, rural street sections are not required to have curb and gutter.</p>
<p>Do adopted street sections allow for the use of open treatment and conveyance of stormwater within landscape strips?</p> 		<p>The code is silent on this design alternative.</p>

What does the new permit mean to me & my community?

4. Remove Barriers

City of Newcastle. 18.21.080 Native vegetation areas.

- A. For the purposes of this Chapter, native vegetation areas shall have a tree density of one native tree for every 600 square feet.
- B. Native vegetation area includes native, undisturbed areas or rehabilitation of previously disturbed areas. Native vegetation areas may integrate passive recreation facilities. Active recreation areas shall not count towards native vegetation areas total.
- C. For the purposes of calculating the required native vegetation area required in 18.21.050-1, inundated lands shall not be included; however, other sensitive areas and their buffers may be included within the Native Vegetation Area boundaries. Land below an ordinary high water mark shall not be counted towards the required native vegetation.
- D. Native Vegetation Areas shall be forested or reforested.
 - 1. Native Vegetation Areas that do not contain sufficient tree canopy coverage shall be planted with native or near native trees at the minimum tree density specified in 18.21.080(A) and shall be replanted in accordance with 18.16.090(C) and (D) for broadleaf and evergreen trees, respectively. This requirement does not apply to areas addressed by Chapter 18.24.
 - 2. Native Vegetation Areas shall be planted with vegetation that is indigenous to the Pacific Northwest or suitable for the Pacific Northwest climate.
 - 3. A minimum of 25% replanted trees shall be of deciduous species and a minimum of 25% replanted trees shall be coniferous species.
- E. Existing native vegetation, forest litter, and understory shall be preserved to the extent possible in the Native Vegetation Areas in order to reduce flow velocities and encourage the dispersion of the storm water on the site. Runoff discharged into native

What does the new permit mean to me & my community?

5. Review & Adopt

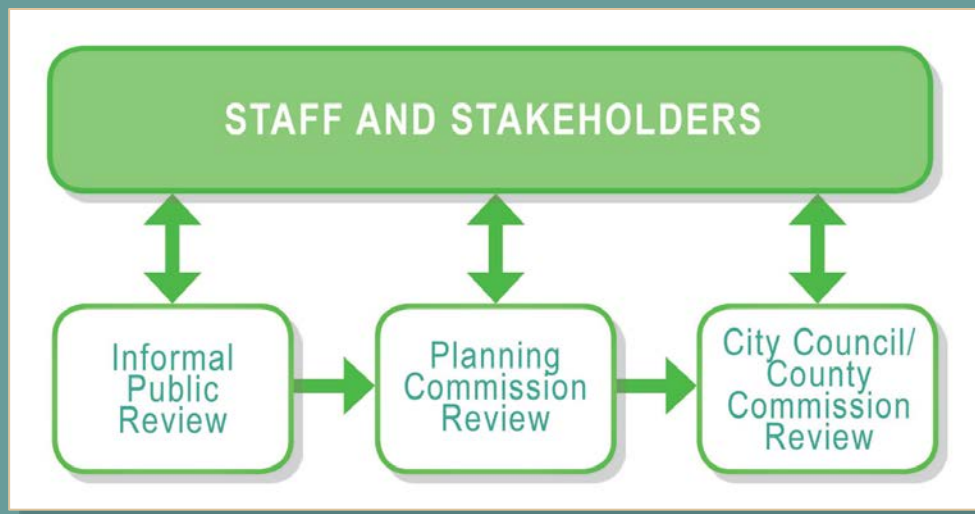

What does the new permit mean to me & my community?

6. Implementation

- The change to LID will represent a paradigm shift that will affect the way you do business
 - Education & Training
 - Maintenance

What does the new permit mean to me & my community?

ASSISTANCE

- Ecology is aware of the work ahead of you and wants to help
 - Resources
 - Contact
 - Feedback

What does the new permit mean to me & my community?

Integrating LID into Local Codes:

A Guidebook for Local Governments

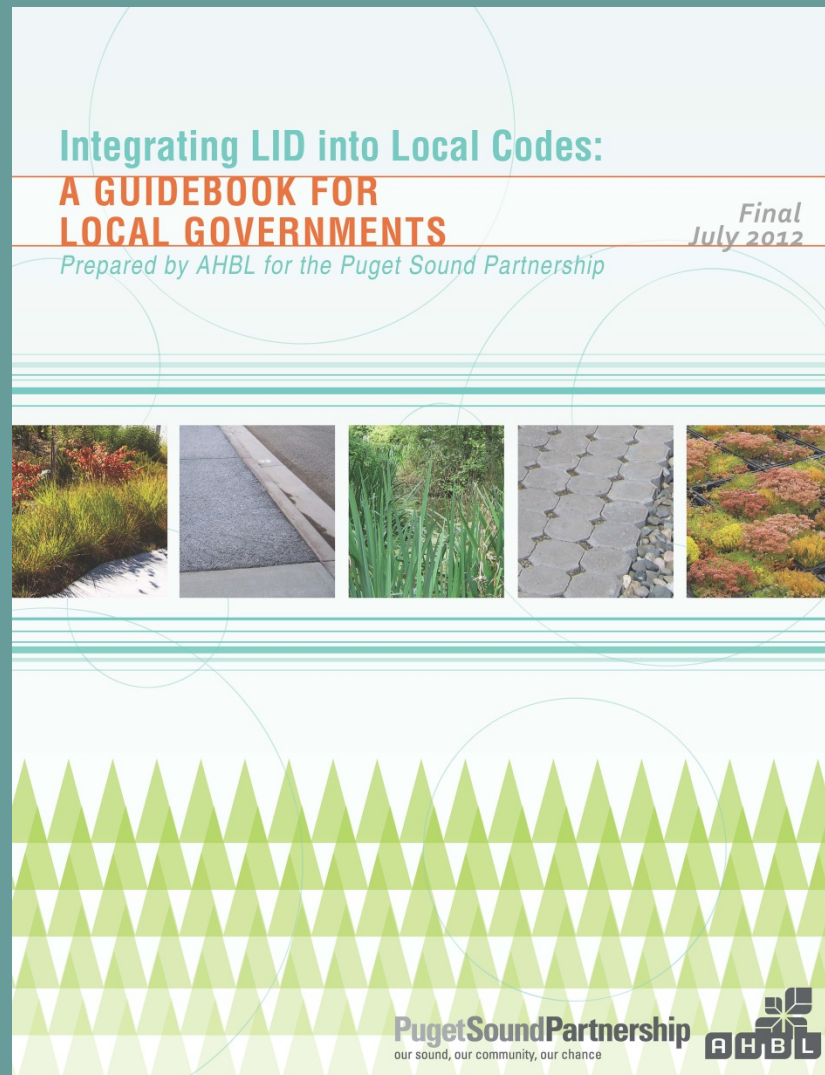

What does the new permit mean to me & my community?

Other Resources:

Ecology's stormwater website:

<http://www.ecy.wa.gov/programs/wq/stormwater/index.html>

Washington Stormwater Center LID portal:

<http://www.wastormwatercenter.org/low-impact/>

EPA's Green Infrastructure website:

<http://water.epa.gov/infrastructure/greeninfrastructure/index.cfm>

Puget Sound Partnership's stormwater and LID website:

<http://www.psp.wa.gov/stormwater.php>

Puget Sound Partnership's Resource Center website:

http://www.psparchives.com/our_work/stormwater/stormwater_resources.htm#bio



What does the new permit mean to me & my community?

Association of Washington Cities LID website:

<http://www.awcnet.org/TrainingEducation/LowImpactDevelopment.aspx>

Other Resources:

Ecology studies:

LID Cost Analysis

Maintenance Manual

Raingarden Handbook (update)

Aesthetics of Low Impact Development
LID Technologies Can Benefit Your Community's Visual Environment

Low Impact Development (LID) Practices Add Natural Beauty
LID practices, which emphasize using natural vegetation to control runoff, can improve aesthetics and enhance property values.

FAQ: Isn't LID unattractive?

Costs of Low Impact Development
LID Saves Money and Protects Your Community's Resources

Are Low Impact Development (LID) Practices More Economical Than Conventional Practices?

FAQ: Isn't LID too costly?

Maintenance of Low Impact Development
Communities Are Easily Managing LID Practices

FAQ: Aren't maintenance costs for LID still unknown?

Barrier Busted!
Results show that life cycle costs of LID are usually less than traditional practices.

LID Barrier Busters Fact Sheet Series

LID Can Be More Cost-Effective Over Time

BMP-REALCOST



Questions & Evaluation

Questions & Evaluation

FEEDBACK

- What do you need from Ecology for your local government to make the transition?
- What does your community need?
 - Training for developers?
 - Public education?

Questions & Evaluation

THANK YOU!

Wayne E. Carlson, AICP, LEED AP

AHBL, Inc.

827 West 1st Avenue

Suite 301

Spokane, WA 99201-3912

(509) 252-5019

wecarlson@ahbl.com

